

6523 MOUNTING
SCREW,
1/4-28 (CAPTIVE)

1.20 MIN. FLAT MOUNTING
SURFACE DIA. (FLAT TO
.001 TIR)

PORT PREPARATION:
DRILL #3 (Ø.213) X .35 MIN DEPTH
TAP 1/4-28 UNF-2B X .25 MIN DEPTH

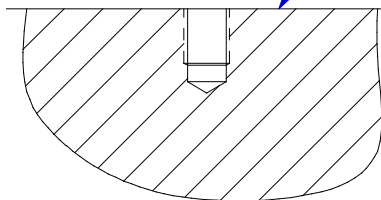

EXCEPT AS OTHERWISE NOTED			
ALL DIMENSIONS IN INCHES TOLERANCE: .XXX = ± .XX = ± .01			
SURFACE FINISH EXCEPT AS NOTED ✓			
BREAK EDGES TO DEBURR RADIUS OR CHAMFER			
△	THESE DIAS	TO	T.I.R.
FILLETS -		MAX RAD.	

		CHATSWORTH, CA.							
						SCALE	1X	REV	-
DATE		4/3/02		PART NO.		MOD 3202A3			
DRAWN		N.C.		CHECKED		R.A.			
APPROVED				NEXT ASSEMBLY		USED ON		3202A3	
TITLE								DWG NO.	
OUTLINE/INSTALLATION DRAWING, MODEL 3202A3								127-3202A3	
								SHEET 1 OF 1	



SPECIFICATIONS

MODEL 3202A3 LIVM ACCELEROMETER

SPECIFICATION	VALUE	UNITS
PHYSICAL		
WEIGHT	180	GRAMS
SIZE, L x D x H	2.278x 1.37 x 1.13	IN
MOUNTING PROVISION, (MOD 6523 SCREW PROVIDED)	THRU HOLE, CAPTIVE 1/4-28 SCREW	
ELECTRICAL CONNECTOR, RADIAL (MIL-C-5015)	2-PIN MILITARY 10SL-4P, HERMETIC	
MATERIAL CASE/CONNECTOR	316L	ST. STEEL
PERFORMANCE		
SENSITIVITY, $\pm 5\%$ [1]	500	mV/G
RANGE FOR ± 5 VOLTS OUT	± 10	G
FREQUENCY RESPONSE, $\pm 5\%$.5 - 5,000	Hz
MOUNTED RESONANT FREQUENCY, TYP.	25	kHz
EQUIV. ELECTRICAL NOISE FLOOR, (RESOLUTION)	.0002	G RMS
AMPLITUDE NON-LINEARITY (ZERO BASED BEST FIT ST.LINE METHOD)	2.0	% F.S., MAX.
TRANSVERSE SENSITIVITY, MAX.	5	PERCENT
STRAIN SENSITIVITY	.0015	G's PER MICROSTRAIN @ 250/ μ
ENVIRONMENTAL		
MAXIMUM VIBRATION	100	G's, RMS
MAXIMUM SHOCK	1500	G's, PEAK
TEMPERATURE RANGE	-60 TO +250	$^{\circ}$ F
ENVIRONMENTAL SEAL	GLASS TO METAL/WELDED,HERMETIC W/IMMERSION PROOF CABLE BOOT FEATURE	
ELECTRICAL		
COMPLIANCE (SUPPLY) VOLTAGE RANGE [2]	+20 to +30	VDC
EXCITATION CURRENT RANGE	2 to 20	mA
OUTPUT IMPEDANCE, NOM.	200	OHMS
OUTPUT BIAS VOLTAGE RANGE	10 to 12.5	VDC
DISCHARGE TIME CONSTANT, MIN.	1.0	SEC.
OUTPUT SIGNAL POLARITY FOR ACCELERATION TOWARD TOP	POSITIVE GOING	
POWER/SIGNAL GROUND to CASE ISOLATION, MIN.	10	MEGOHMS

SUPPLIED ACCESSORIES:

(1) MODEL 6523, 1/4-28 MOUNTING SCREW.

NOTES:

- [1] MEASURED AT 100 Hz, 1 G RMS. A CALIBRATION CERTIFICATE TRACEABLE TO **NIST** IS SUPPLIED WITH EACH INSTRUMENT.
- [2] THE USE OF DYTRAN LIVM CURRENT SOURCE POWER UNITS IS RECOMMENDED. **DO NOT CONNECT THIS INSTRUMENT TO A SOURCE OF DC VOLTAGE WITHOUT CURRENT LIMITING PROTECTION, 20 mA MAX.** TO DO SO WILL DESTROY THE INTERNAL AMPLIFIER AND VOID THE WARRANTY.