

10SL-4P CONNECTOR,
HERMETIC

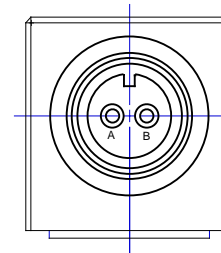
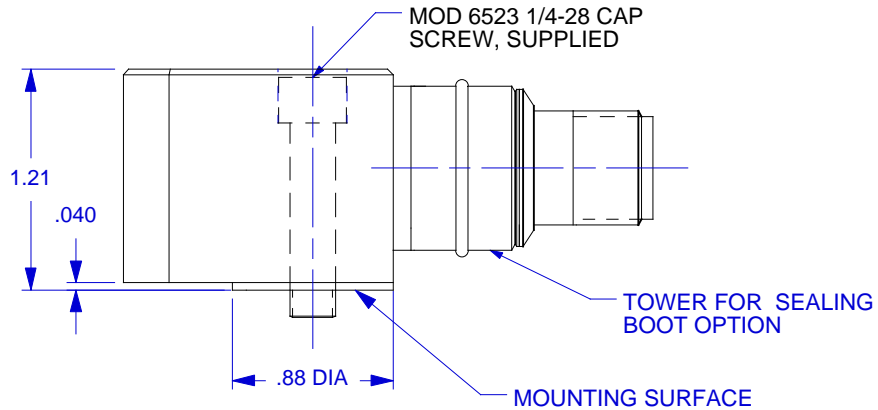

PIN A: SIG/PWR
PIN B: GND RETURN

- 1) POWER GROUND IS INSULATED FROM CASE BY >10 MEGOHMS.
- 2) SEAL: HERMETIC.

EXCEPT AS OTHERWISE NOTED

ALL DIMENSIONS IN INCHES
TOLERANCE: .XXX ± .005 .XX ± .01

SURFACE FINISH
EXCEPT AS NOTED ✓

BREAK EDGES TO DEBURR
RADIUS OR CHAMFER

△ THESE DIAS ⊙ TO .005 T.I.R.

FILLETS - MAX RAD.



CHATSWORTH, CA.

SCALE	1X	REV	-	DATE	-	ECN	-
DATE	7-29-02	PART NO.	MODELS 3166B & B1				
DRAWN	N.C.	CHECKED	R.A.	MAT'L	-		
APPROVED				NEXT ASSEMBLY	USED ON 3166B, 3166B1		
TITLE						DWG NO.	
OUTLINE/INSTALLATION DRAWING, MODELS 3166B & 3166B1						127-3166B	
						SHEET 1 OF 1	



SPECIFICATIONS

MODELS 3166B and 3166B1 LIVM ACCELEROMETER

SPECIFICATION	VALUE	UNITS
PHYSICAL		
WEIGHT	228	GRAMS
SIZE, L x W x H	2.90 x 1.00 x 1.21	IN
MOUNTING PROVISION, (MOD 6523 SCREW PROVIDED)	THRU HOLE, CAPTIVE 1/4-28 SCREW	
ELECTRICAL CONNECTOR, RADIAL	2-PIN MILITARY 10SL-4P, HERMETIC	
MATERIAL CASE/CONNECTOR	316L	ST. STEEL
ELEMENT STYLE	CERAMIC PLANAR SHEAR	
PERFORMANCE		
SENSITIVITY, +/- 5% 3166B/3166B1 [1]	100/500	mV/G
RANGE FOR +/- 5 VOLTS OUT, 3166B (3166B1)	+/-50/+/- 10	G
FREQUENCY RESPONSE, ± 5%, 3166B (3166B1)	.5 - 5,000 (.5 -1000)	Hz
	± 3 db, 3166B (3166B1)	Hz
	.2 -12,000 (.2 -3,000)	kHz
MOUNTED RESONANT FREQUENCY, TYP.	21 (16)	G RMS
EQUIV. ELECTRICAL NOISE FLOOR, (RESOLUTION) 3166B (3166B1)	.00006 (.00002)	% F.S., MAX.
AMPLITUDE NON-LINEARITY (ZERO BASED BEST FIT ST.LINE METHOD)	2.0	PERCENT
TRANSVERSE SENSITIVITY, MAX.	5	G's PER MICROSTRAIN @ 250/μ
STRAIN SENSITIVITY	.0001	
ENVIRONMENTAL		
MAXIMUM VIBRATION	350	G's, RMS
MAXIMUM SHOCK	3000	G's, PEAK
TEMPERATURE RANGE	-60 TO +250	°F
ENVIRONMENTAL SEAL	GLASS TO METAL/WELDED,HERMETIC	
ELECTRICAL		
COMPLIANCE (SUPPLY) VOLTAGE RANGE [2]	+20 to +30	VDC
EXCITATION CURRENT RANGE	2 to 20	mA
OUTPUT IMPEDANCE, NOM.	200	OHMS
OUTPUT BIAS VOLTAGE,	10.0 to 12.0	VDC
DISCHARGE TIME CONSTANT, MIN. 3166B (3166B1)	1.0 (1.0)	SEC.
OUTPUT SIGNAL POLARITY FOR ACCELERATION TOWARD TOP	POSITIVE GOING	
POWER/SIGNAL GROUND to CASE ISOLATION, MIN	10	MEGOHMS

SUPPLIED ACCESSORIES:

- (1) Model 6523, 1/4-28 MOUNTING SCREW

[1] MEASURED AT 100 Hz, 1 G RMS. A CALIBRATION CERTIFICATE TRACEABLE TO NIST IS SUPPLIED WITH EACH INSTRUMENT.

[2] THE USE OF DYTRAN LIVM CURRENT SOURCE POWER UNITS IS RECOMMENDED. **DO NOT CONNECT THIS INSTRUMENT TO A SOURCE OF DC VOLTAGE WITHOUT CURRENT LIMITING PROTECTION, 20 mA MAX.** TO DO SO WILL DESTROY THE INTERNAL AMPLIFIER AND VOID THE WARRANTY.